

CONTA-CABLE/ KDSI-SR CABLE ENTRIES

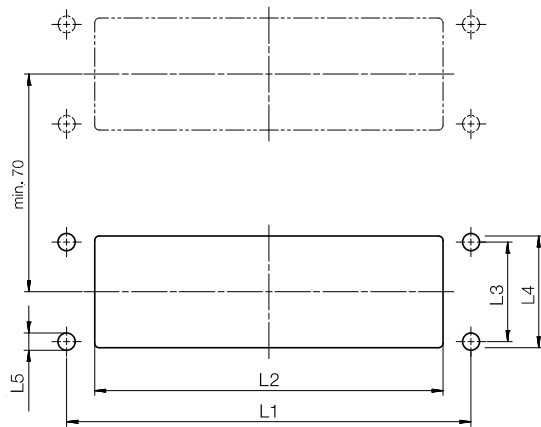

● ○
EN DE

PRODUCT DATA

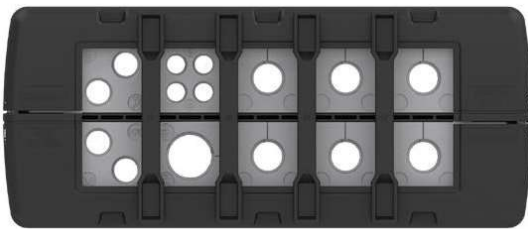

CUT-OUT DIMENSIONS

Frame	Cat.no.	L1(mm)	L2(mm)	L3(mm)	L4(mm)	L5(mm)
KDSI-SR 1-4	28880.4	58	46	32	36-46	5.5
KDSI-SR 6/10	28881.4	83	68.5	32	36-46	5.5
KDSI-SR 8/16	28882.4	103	91	32	36-46	5.5
KDSI-SR 10/24	28883.4	130	113.5	32	36-46	5.5

USAGE OPTIONS

Frame	Inlay			
	1	2	4	6
KDSI-SR 1-4	28516.4	28517.4	28518.4	28519.4
KDSI-SR 6/10		x	x	x
KDSI-SR 8/16	x		x	
KDSI-SR 10/24		x	x	x

INSTALLATION

- Insert frame and screws from outside.
- Insert washers and nuts. Tighten nuts from inside with 3 Nm torque.
- Guide cables through frame.
- Click inlays into position.
- Attach seals to cables.
- Push seals all the way in.
- Assemble hood.
- Snap hood onto frame.

OPTIONAL OUTER LOCKING BARS

- Snap the optional locking bars into position in the frame.

TO REMOVE THE HOOD

- Remove optional locking bars. Press tabs on sides and pull apart.